

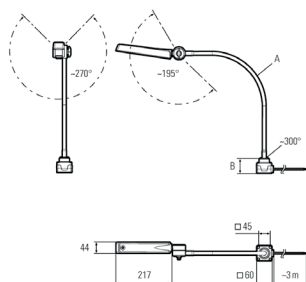

CENALED FLOOD Flexarm DC

Artikelnr.: 121210-01
EAN: 4260556626307

| | |
|-------------------------------|---|
| Bestell-Nr.: | 121210-01 |
| Modell: | CENALED |
| Bauform: | LED-Arbeitsleuchte |
| Leuchtmittel: | SMD-LED |
| Lampenleistung: | ~8,4 W |
| Lampenlichtstrom: | 1260lm |
| Lampenlichtausbeute: | 150lm/W |
| Lichtverteilung: | direkt |
| Lichtfarbe: | 5700K |
| Anschlusswert Leuchte: | 24V DC \pm 10% |
| Betriebsgerät: | - |
| Anschluss Leuchte: | 3 m Anschlussleitung, Ölflex, mit offenen Leitungsenden |
| Schutzart: | IP67 |
| Schutzklasse: | III |
| Abstrahlwinkel: | 118° -> Halbwertswinkel |
| Betriebstemperatur: | -10... +50 °C |
| Farbwiedergabe (Ra): | > 5 |
| Lampenlebensdauer: | > 0.000 h |
| Material Gehäuse: | Aluminium (pulverlackiert) |
| Material Abdeckung: | Sicherheitsglas |
| Länge Flexarm [A]: | 500 mm |
| Sockelhöhe (B): | 59 mm |
| Befestigung: | Anschraubsockel |
| Gewicht: | ~1500 g |
| Bruttogewicht: | ~2100 g |
| Befestigungszubehör: | optional |
| Dimmbar: | ja, über Taster am Leuchtenkopf, Ein/Aus und Dimmen |
| Kennzeichnung: | CE, UKCA, ETL Listed (5003529) |
| Gefertigt in: | Deutschland |



Lampenlebensdauer in Betriebstunden (L80/B10)



CENALED FLOOD Flexarm DC

| | |
|----------------------------------|--|
| Item number: | 121210-01 |
| EAN: | 4260556626307 |
| Order number: | 121210-01 |
| Model: | CENALED |
| Type: | LED workplace light |
| Illuminant: | SMD-LED |
| Power consumption: | ~8,4 W |
| Lamp luminous flux: | 1260lm |
| Lamp luminous efficiency: | 150lm/W |
| Light distribution: | direct |
| Light colour: | 5700K |
| Connected load: | 24V DC \pm 10% |
| Power supply: | - |
| Connection (connector): | connection cable 3m (9,84 ft), flexible, two open cable ends |
| Degree of protection: | IP67 |
| Class of protection: | III |
| Beam angle (optics): | 118° -> half value angle |
| Operating temperature: | -10... +50 °C (14... 122 °F) |
| Colour rendering (Ra): | > 85 |
| Lamps lifetime: | > 60,000 h |
| Housing material: | aluminium (powder finished) |
| Cover material: | safety glass |
| Length Flexarm [A]: | 500 mm (19,69") |
| Base height (B): | 59 mm (2,32") |
| Mounting: | screw-on base |
| Weight (net): | ~1500 g (~53 oz) |
| Gross weight: | ~2100 g (~74 oz) |
| Mounting accessories: | optional |
| Dimmable: | yes, via push button at the light head, ON/OFF and dimming |
| Marking: | CE, UKCA, ETL Listed (5003529) |
| Made in: | Germany |

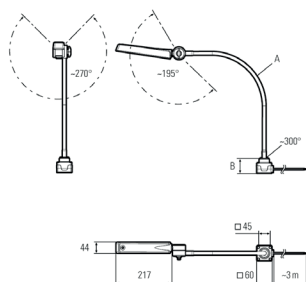

Lamps lifetime in operation hours (L80/B10)